

# MONACO COMPONENTS, INC.

BUILT-IN DRIVE STYLE PCB MOUNTING

**2000  
series**

- Small size and lightweight.
- High efficiency
- Low current drain.

MODEL	MPB-2230	MPB-2232	MPB-2231	MPB-2233
FREQUENCY *	3200 HZ ± 500 Hz			
DRIVING CIRCUIT	BUILT IN			
OPERATING VOLTAGE	3 - 20 V			
RATED VOLTAGE	12 V			
SOUND PRESSURE *	75 dB MIN. @ 30 cm	82 dB MIN. @ 30 cm	75 dB MIN. @ 30 cm	82 dB MIN. @ 30 cm
CURRENT CONSUMPTION *	12 mA MAX.	10 mA MAX.	12 mA MAX.	9 mA MAX.
-tone	CONTINUOUS			
CONNECTION STYLE	PCB MOUNT (PINS) : 15.0		PCB MOUNT (PINS) : 17.5	
OPERATING TEMPERATURE	-20° to +60° C			

\* VALUES AT RATED VOLTAGE

MPB-2230  
MPB-2232

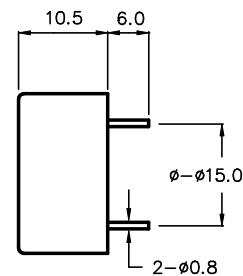
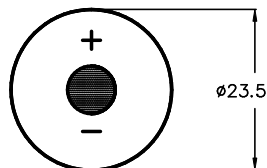

MPB-2231  
MPB-2233

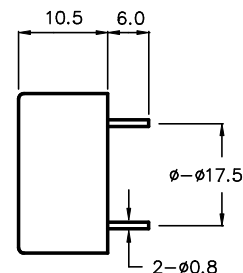
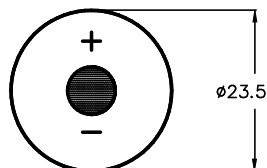

ALL DIMENSIONS IN mm

SPECIFICATIONS SUBJECT TO CHANGE WITHOUT NOTIFICATION / MODELS SHOWN SUBJECT TO LIMITED WARRANTY

**SALES OFFICE (516)-767-6644**

CORPORATE OFFICE

P.O. Box 575, Scotch Plains, NJ. 07076

Phone: (908)-322-2977 Fax: (908)-322-2358

E-mail: [info@monacocomponents.com](mailto:info@monacocomponents.com)

[www.monacocomponents.com](http://www.monacocomponents.com)